

FOR IMMEDIATE RELEASE

08/15/2017

MEDIA CONTACT

Elise Brooking
Marketing & PR Associate
Kirksey
713 426 7555
eliseb@kirksey.com



6909 Portwest Drive
Houston Texas 77024
713 850 9600
kirksey.com

HCC Celebrates Grand Opening at New Missouri City Campus

***Kirksey Architecture designed the new Center for Entrepreneurship,
Technology and Health (CETH) Campus***

MISSOURI CITY, TEXAS – Houston Community College held a ribbon cutting for the new Missouri City campus on Tuesday, August 15. The celebration marked the opening of the Center for Entrepreneurship, Technology and Health (CETH), designed by Kirksey Architecture. Turner Construction was the general contractor and Jones Lang LaSalle served as the project manager.

The new 69,000 square foot facility, located at 1522 Texas Parkway near Missouri City Hall, includes state-of-the-art classrooms, healthcare workforce training spaces, conference rooms, computer labs, a biology lab, exhibition space, student lounge, and a multi-purpose space for the Center for Entrepreneurship. The CETH Missouri City campus will offer courses in computer programming and coding, emergency medical technician (EMT) and medical assistant training, as well as small business administration. HCC focuses on aligning educational programs with regional needs to help fill skills gaps in the market.

To accommodate the needs of the health career programs, the CETH building will offer prerequisite courses for more than 20 professional health career programs at HCC Coleman College for Health Sciences. The new campus includes specialized instructional spaces and clinical labs for nursing, medical assisting, respiratory therapy, retail pharmacy, health information technology and mental health programs.

The center will offer Associate of Arts (AA), Associate of Science (AS), and Associate of Applied Science (AAS) degrees, which are all transferable to any four-year Texas university. Fall classes will begin on Monday, August 28th.

- Photos below -



Photos courtesy of HCC

- Building photos continued below -

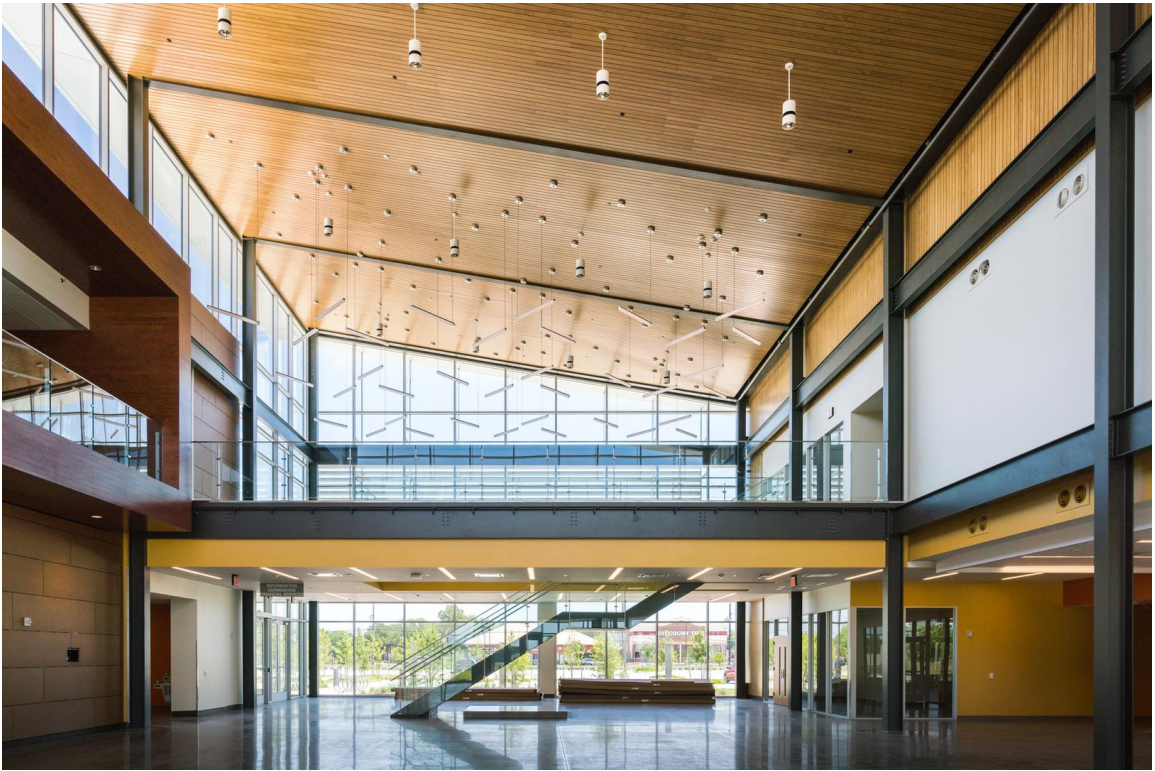

- Continued below -



Photos by Ruben Serrano

Kirksey is a Houston-based, sustainable architecture and interior design firm with more than 33 million sf of LEED® projects in their portfolio. Team-based in structure, Kirksey serves Commercial, Collegiate, Community, pK-12, Government, Healthcare, Hospitality, Religious, Science & Technology, and Multi-Family Residential markets.

####